

**Harbourfront Public Furniture Competition**  
**Annex 1: Basic Requirements**

The Competition will focus on three promenades with a theme on “Design by Victoria Harbour”. Basic requirements are highlighted as below:

Location	Three promenades at Victoria Harbour
Theme	(1) Beautify the harbourfront and bring joyful experience to visitors; (2) Facilitate the promotion of the Victoria Harbour and its harbourfront; (3) Creative, vibrant and interesting with due consideration to the normal height and comfort for furniture; and (4) Incorporate “Victoria Harbour” logo.
Furniture Type	Public furniture such as seating and table, etc. which can encourage interaction with the Harbour and bring joyful experience to visitors to the areas.
Furniture Mounting	Free standing*
Location	The installation locations are at the promenade shown in the below plans
Maximum Allowable Load	Consideration must be given to the loading capacity and point of weight to avoid causing ground settlement
Furniture Plinth	If a plinth is required, all associated costs of the plinth including necessary shoring for excavation should be covered by the commissioning budget.
Power Outlet / Capacity	Not provided
Feature Lighting / Power Point Provision for Lighting	Not provided
Other Remarks	<ul style="list-style-type: none"> <li>a. For installations, consideration must be given to the loading capacity and point of weight. If additional support is necessary for any of the Furniture, all the relevant cost of the support including necessary shoring for excavation should be covered by the commissioning budget.</li> <li>b. During dismantling after display, the winning teams are required to reinstate the locations back to the states before the Furniture are installed. All the relevant costs of the reinstatement works should be covered by the commissioning budget.</li> <li>c. Materials used for the Furniture should comply with the building, health regulations and safety standards.</li> <li>d. Due regard should be given to safety, ergonomics and height design of facilities if especially for use by children or people with special needs.</li> <li>e. The pedestrian flow shall not be obstructed. Footpath with minimum 2000mm clear width shall be maintained;</li> </ul>

Note: Materials and information provided are for reference only and are subject to change without further notice. Sketches, drawings and images are not necessarily drawn to scale.

\* For Furniture to be affixed onto a wall, the design has to take into consideration the structure of the wall and of the mounting support (if applicable), as well as the load-bearing areas of the wall.

## Installation Locations of Public Furniture

Each Participant may submit no more than two separate Proposals for the public furniture to be installed at the following promenade.

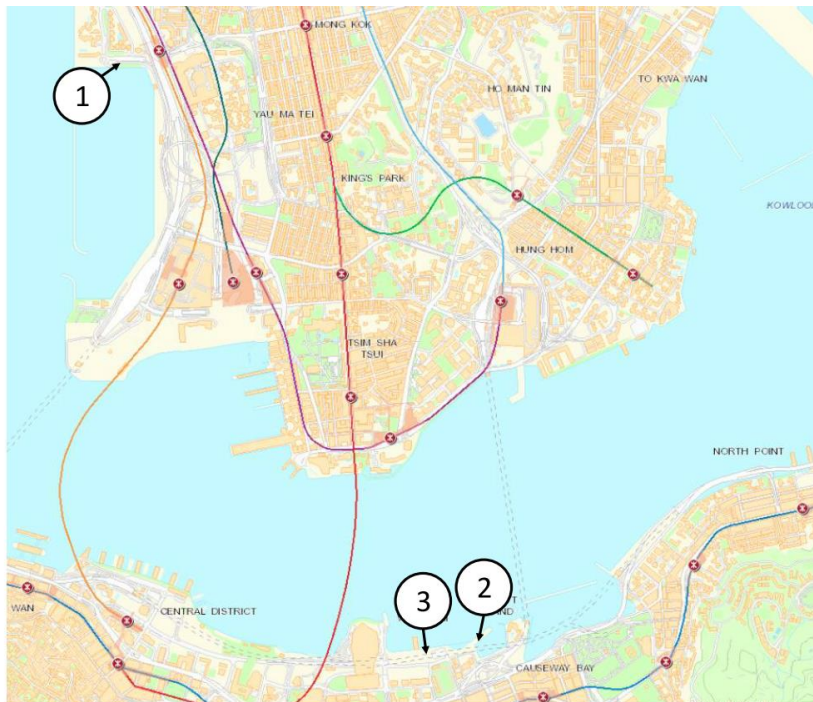

### 1. Hoi Fai Road Promenade

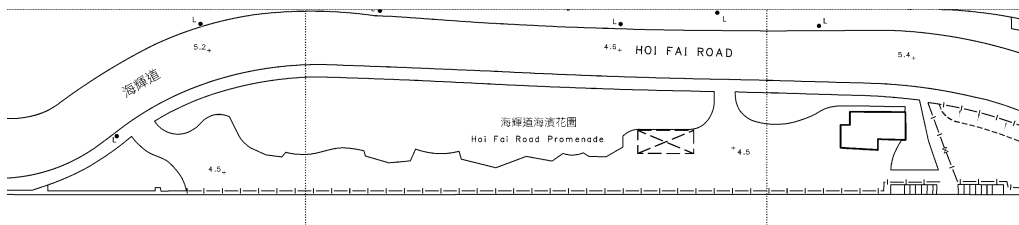

Site Plan



Site Photo†

The promenade was open to public in 2014.

† Source of photo:

<https://www.google.com.hk/maps/@22.3169298,114.1587896,3a,75y,299.56h,89.35t/data=!3m8!1e1!3m6!1sAF1QipNesqWaQxhZws4NtCU8xgy6avH0cdfJF6Xhgxt-!2e10!3e11!6shttps:%2F%2Fih5.googleusercontent.com%2Fp%2FAF1QipNesqWaQxhZws4NtCU8xgy6avH0cdfJF6Xhgxt-%3Dw203-h100-k-no-pi-0-ya263.19403-ro0-fo100!7i10240!8i5120?hl=zh-TW>

## 2. Promenade at Water Sports and Recreation Precinct

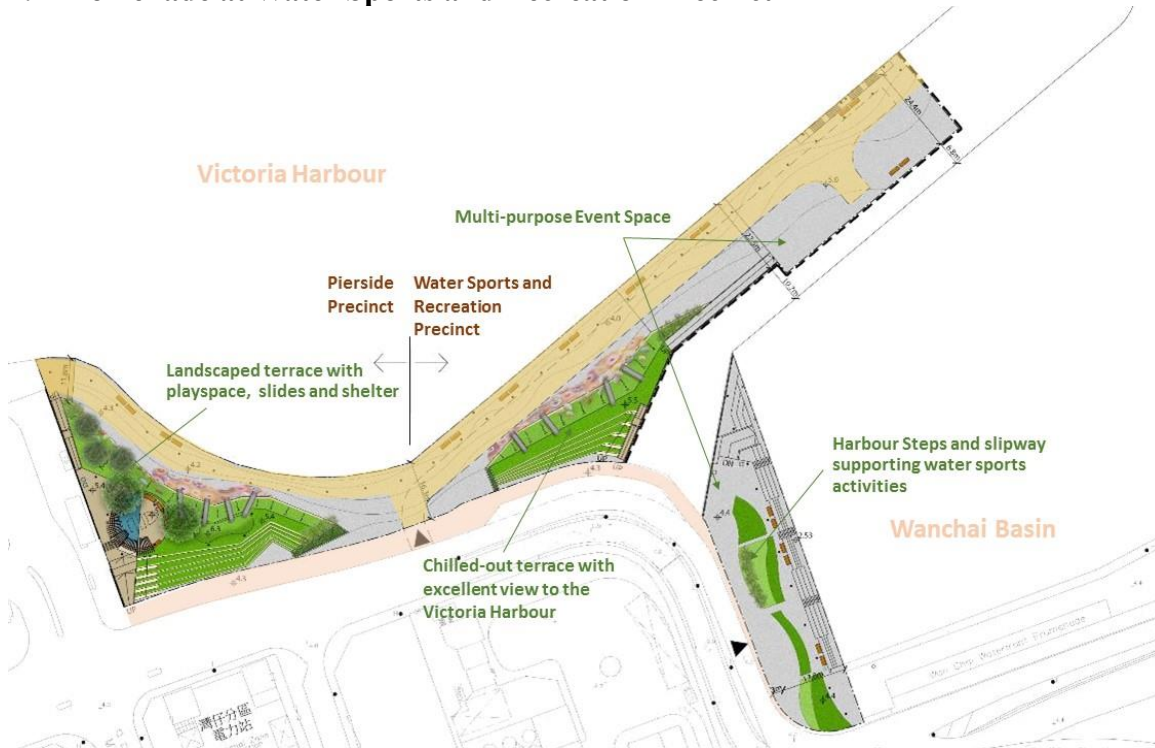

Please click the following link to download more details of the promenade:  
[https://www.hfc.org.hk/en/task\\_forces/hk\\_island/meeting\\_20200515.html](https://www.hfc.org.hk/en/task_forces/hk_island/meeting_20200515.html)

## 3. Promenade at Pierside Precinct

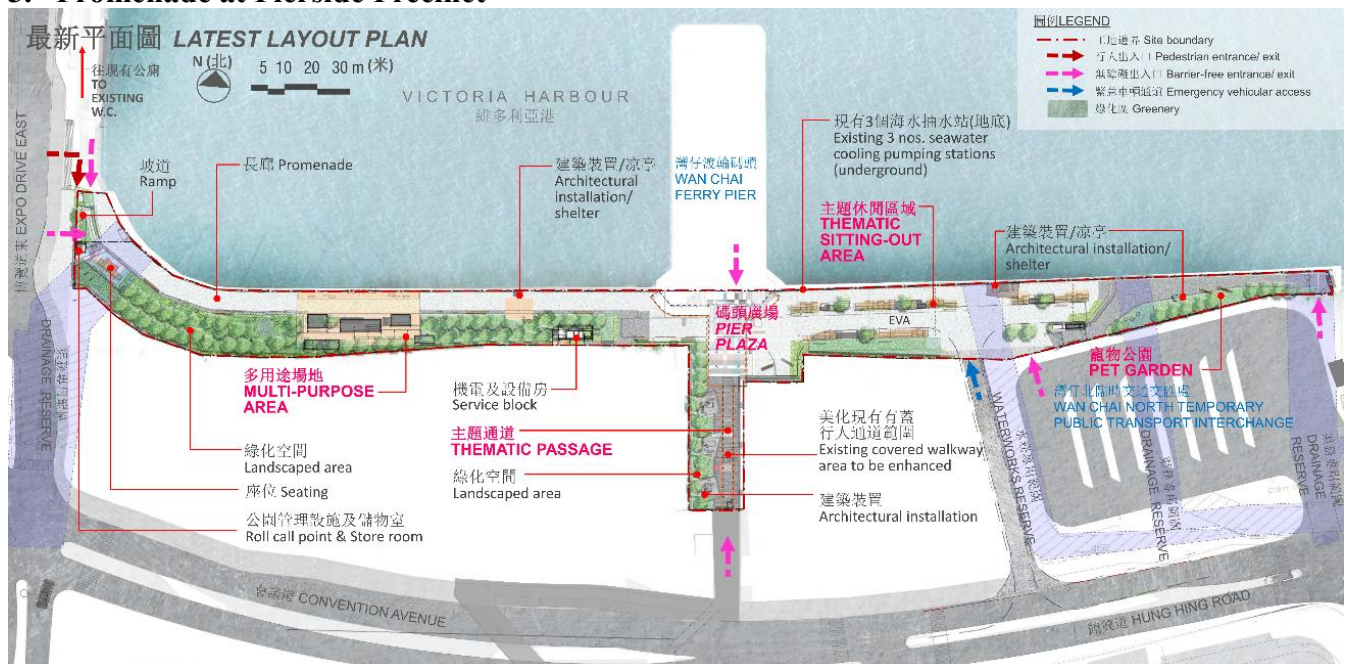

Please click the following link to download more details of the promenade:  
[https://www.hfc.org.hk/en/task\\_forces/hk\\_island/meeting\\_20180907.html](https://www.hfc.org.hk/en/task_forces/hk_island/meeting_20180907.html)