

ISO A1 594mm x 841mm
Approved:
Checked:
Designer:
Project Management Initials:
Plot File by: Setof
PATH: P:\PROJECTS\60597457\DRAWING\REPORT\GAZ_401.dwg

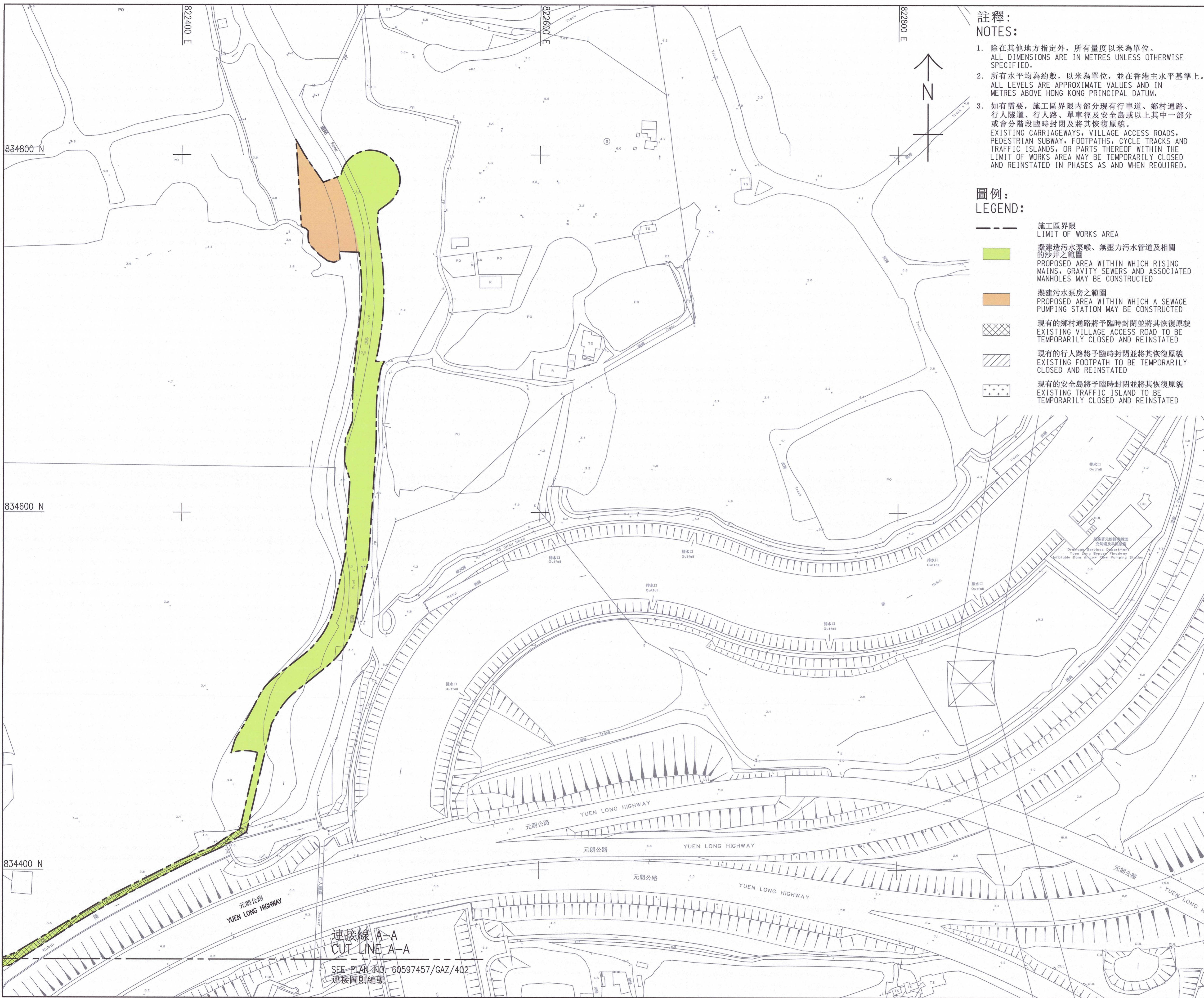

註釋:
NOTES:

- 除在其他地方指定外，所有量度以米為單位。
ALL DIMENSIONS ARE IN METRES UNLESS OTHERWISE SPECIFIED.
- 所有水平均為約數，以米為單位，並在香港主水平基準上。
ALL LEVELS ARE APPROXIMATE VALUES AND IN METRES ABOVE HONG KONG PRINCIPAL DATUM.
- 如有需要，施工區界限內部分現有行車道、鄉村通路、行人隧道、行人路、單車徑及安全島或以上其中一部分或會分階段臨時封閉並將其恢復原貌。
EXISTING CARRIAGEWAYS, VILLAGE ACCESS ROADS, PEDESTRIAN SUBWAY, FOOTPATHS, CYCLE TRACKS AND TRAFFIC ISLANDS, OR PARTS THEREOF WITHIN THE LIMIT OF WORKS AREA MAY BE TEMPORARILY CLOSED AND REINSTATED IN PHASES AS AND WHEN REQUIRED.

圖例:
LEGEND:

- 施工區界限
LIMIT OF WORKS AREA
- 擬建造污水泵喉、無壓力污水管道及相關的沙井之範圍
PROPOSED AREA WITHIN WHICH RISING MAINS, GRAVITY SEWERS AND ASSOCIATED MANHOLES MAY BE CONSTRUCTED
- 擬建污水泵房之範圍
PROPOSED AREA WITHIN WHICH A SEWAGE PUMPING STATION MAY BE CONSTRUCTED
- ▨ 現有的鄉村通路將予臨時封閉並將其恢復原貌
EXISTING VILLAGE ACCESS ROAD TO BE TEMPORARILY CLOSED AND REINSTATED
- ▨ 現有的行人路將予臨時封閉並將其恢復原貌
EXISTING FOOTPATH TO BE TEMPORARILY CLOSED AND REINSTATED
- ▨ 現有的安全島將予臨時封閉並將其恢復原貌
EXISTING TRAFFIC ISLAND TO BE TEMPORARILY CLOSED AND REINSTATED

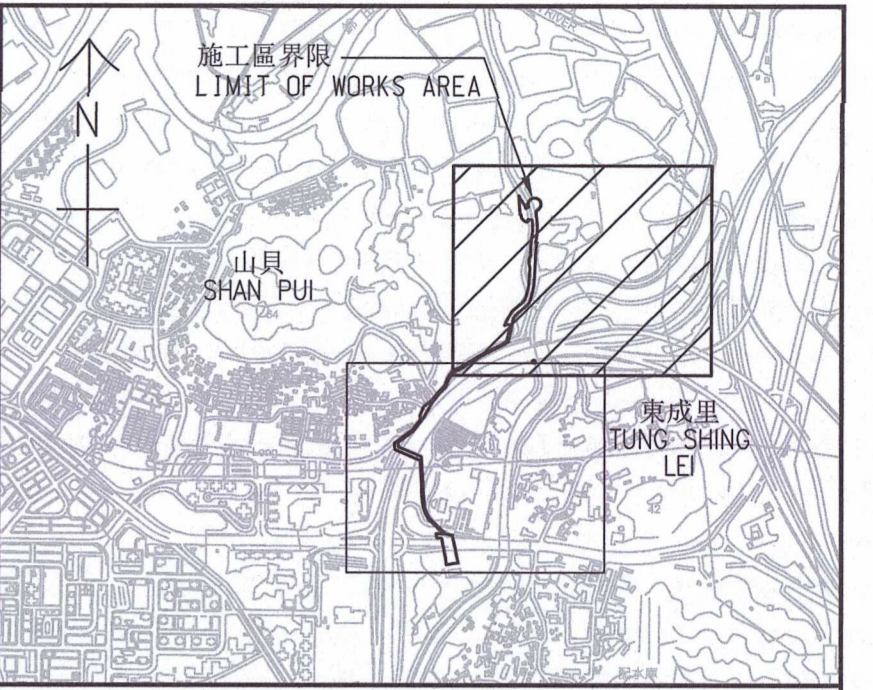

索引圖 KEY PLAN
比例 SCALE 1:20000

批註 ENDORSED BY

JACKSON W C LING

凌偉志
JACKSON W C LING
環境保護署
高級環境保護主任 (排污基建)
SENIOR ENVIRONMENTAL PROTECTION OFFICER
(SEWERAGE INFRASTRUCTURE GROUP)
ENVIRONMENTAL PROTECTION DEPARTMENT
日期 DATE 08.10.2024

核准 APPROVED BY

YVONNE C L LO

盧秋玲
YVONNE C L LO
渠務署
總工程師 / 新界北
CHIEF ENGINEER / MAINLAND NORTH
DRAINAGE SERVICES DEPARTMENT
日期 DATE 13.09.2024

工程名稱 Project title
土地共享先導計劃 (申請編號: LSPS/002) - 元朗蠔洲路近東成里房屋發展之工地平整及基礎設施工程 (排污設備工程)
LAND SHARING PILOT SCHEME (APPLICATION NO. LSPS/002) - SITE FORMATION AND INFRASTRUCTURE WORKS FOR HOUSING SITE DEVELOPMENT AT HO CHAU ROAD NEAR TUNG SHING LEI, YUEN LONG (SEWERAGE WORKS)

圖則名稱 Plan title
根據《水污染管制(排污設備)規例》(第358章, 附屬法例AL)第26條引用《道路(工程、使用及補償)條例》(第370章)在憲報公布之圖則
PLAN FOR GAZETTING UNDER ROADS (WORKS, USE AND COMPENSATION) ORDINANCE (CHAPTER 370) AS APPLIED BY SECTION 26 OF THE WATER POLLUTION CONTROL (SEWERAGE) REGULATION (CHAPTER 358, SUBSIDIARY LEGISLATION AL)

二張之第一張
SHEET 1 OF 2

圖則編號 Plan no. 60597457/GAZ/401
比例 Scale 1:1000(A1)

辦事處 Office
操作維修科 新界北渠務部
MAINLAND NORTH DIVISION
OPERATIONS & MAINTENANCE BRANCH



連接線 A-A
CUT LINE A-A
SEE PLAN NO. 60597457/GAZ/402
連接圖則編號

